

### Revision History

Revision	Date	Initiator	Reason for Change
0	2009/05/06	Anny Xie	New Issue
1	2012/03/19	Irence Ling	Modify the "Shelf Life" : "Not less than 90% of the service capacity within first year storage at 20 ± 2°C 55 ± 20%RH"
2	2012/03/29	Irence Ling	Modify the "Description"

Prepared By	Approved By
Irence Ling	Edward Chan 
Date: 2012/03/29	Date: 2012/03/29

### GPI International Limited

Gold Peak Building, 8/F, 30 Kwai Wing Road,  
Kwai Chung, New Territories, Hong Kong.  
Tel: (852) 2484 3333 Fax: (852) 24805912  
Email: [gpii@goldpeak.com](mailto:gpii@goldpeak.com)  
Website: <http://www.gpbatteries.com.hk>

Model No.: **GP11AF**

<b>Description</b>	: Mercury Free & Lead Free Alkaline High Voltage Multicell
<b>Nominal Voltage</b>	: 6Volts
<b>Nominal Dimensions</b>	: Ø10.22mm×16.5mm
<b>Terminal</b>	: Nickel plated flat contacts - protruded red(+); recessed black (-)
<b>Jacket</b>	: Metal jacket
<b>Internal Connection</b>	: Pressure
<b>Applications</b>	: Remote controller
<b>Average Weight</b>	: 4.0g
<b>Date Code</b>	: Unless otherwise specified, each batteries will carry a numeric year code and analogue month code (+)
<b>Shelf Life</b>	: Not less than 90% of the service capacity within first year storage at 20 ± 2 °C 55 ± 20 %RH
<b>Insulation</b>	: 5MΩ min.
<b>Resistance</b>	
<b>Close Circuit Voltage</b>	: 4.7 Volts (min.)(load resistor 400Ω at 20 ± 2 °C for 0.1 to 2 seconds)
<b>Current Drain</b>	: Under 15mA pulse, 0.5mA continuous
<b>Nominal Service Life</b>	: 74hrs (at 10kΩ load) (to 3.0V at 20 ± 2 °C)
<b>Average Service</b>	: 38mAh(at 10kΩ load)
<b>Capacity</b>	(to 3.0V at 20 ± 2 °C)

**Cross References:**

GP	Eveready	Duracell	Varta
11AF	---	---	---

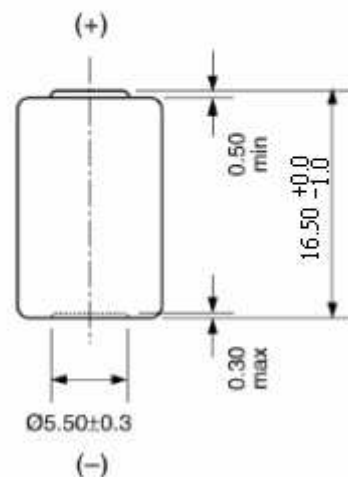
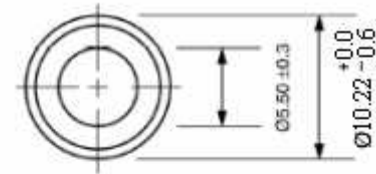

Unit : mm

**Typical Discharge characteristics at 20 ± 2 °C**

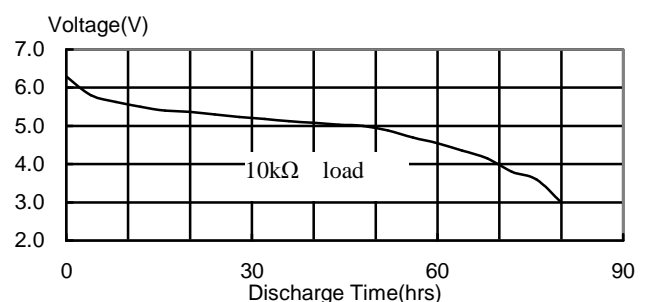

The information (subject to change without prior notice) contained in this document is for reference only and should not be used as a basis for product guarantee or warranty. For applications other than those described here, please consult your nearest GP Sales and Marketing Office or Distributors.