

**cell type:** Li-Ion  
**cell size:** 18650  
**built-in cell:** LG INR 18650 B4 2600mAh

**Conditions**

**nominal voltage:** 3.6 V

**capacity**  
 nominal: 2600 mAh discharge at 0.2C  
 minimum: 2500 mAh discharge at 0.2C  
 2350 mAh discharge at 1C  
 ta: 20°C; EV(Discharge End Voltage): 2.75V

**discharge**  
 max. continuous discharge current: 5000 mA ta: 0...45°C  
**important:** avoid cell temperature above 60°C

discharge end voltage: ≥ 2.75 V (recommended)  
**important:** avoid long time deep discharge

**charge**  
 charging method: CC - CV (Constant Current - Constant Voltage)

initial charge current: 520 mA at standard charge  
 1300 mA at rapid charge

charge end voltage: 4.2 V ± 50mV

charge cut off by time: 6 h at standard charge  
 3 h at rapid charge  
 by current drop: 26 mA (0.01C)

**internal resistance:** ≤ 120 mOhms at 1kHz, sine wave measurement according to IEC 896-2

energy: 9.36 W

**safety board protection functions**

overcharge cut off voltage: 4.325 V ± 0.05V  
 deep disch.cut off voltage: 2.5 V ± 0.1V  
 overload cut off current: 8 A ± 2A

**life time expectance**  
 (C>70% of min. capacity) ≥ 300 cycles at 0.5C charge/discharge rate

**self discharge:** ≤ 2 %/month at 20°C  
 ≤ 5 %/month at 30°C  
 ≤ 10 %/month at 40°C

**ambient temperature range:**

0...45 °C charge  
 0...60 °C discharge  
 - 20...25 °C storage max. 1year  
 - 20...45 °C storage max. 3months

preferred charge state for long time storage: 30...50%

**mechanical specifications**  
 cell dimensions (incl. sleeve)

diameter d1: 18.5 ± 0.3 mm  
 diameter d2: 3.5 ± 0.5 mm  
 height h1: 70.0 - 2 mm  
 height h2: 1.5 + 0.3 mm  
 weight: 46 ± 3 g

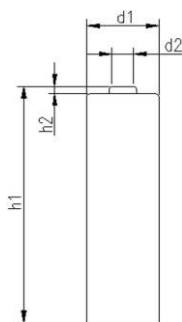

Blister card



	<b>ANSMANN Specifications for model:</b>	<b>Li - Ion Battery 3.6V 2600mAh with Protection Board (PCB) inside</b>
	data sheet no. / part no.	1307-0000
	supplier no.	703365
	author / date	TG / 30.01.2018